

Damper adjustment:

Basic setting: 10 clicks.

Maximum open valve (soft): 16 clicks.

The number of clicks are counted
counter clockwise from fully closed.

Service intervals:

Road use: Every 10.000 km (6.500 miles).

Road racing: Every 20 hours.

Always replace the rubber reservoir
2213-01 when changing oil.

NOTE!

*Discarded Öhlins products should be handled
over to an authorized work shop or distributor
for proper disposal.*



Öhlins Racing AB
Box 722, S-194 27 Upplands Väsby, Sweden.
Phone +46 8 590 025 00, fax +46 8 590 025 80.
E-mail: info@ohlins.se
www.ohlins.com

07261-01, Teknisk Illustration, OM Steering Dampers R&T 03 04, 500 ex

Owners Manual

Öhlins ROAD & TRACK steering dampers



Including:

Safety

Design
features

Basic
adjustments

Technical
information

Safety signals

Important information concerning safety is distinguished in this manual by the following notations:



*The Safety alert symbol means:
Caution! Your safety is involved.*

⚠ WARNING!

*Failure to follow warning instructions could result in **severe or fatal injury** to anyone working with, inspecting or using the suspension, or to bystanders.*

CAUTION!

Caution indicates that special precautions must be taken to avoid damage to the suspension.

NOTE!

This indicates information that is of importance with regard to procedures.

Introduction

Öhlins steering dampers are designed to withstand very tough treatment in conjunction with competitions. Many years experience and close cooperation with World Championship teams in road racing has helped us develop unique know-how.

Before installation

Öhlins Racing AB can not be held responsible for any damage whatsoever to shock absorber or vehicle, or injury to persons, if the instructions for fitting and maintenance are not followed exactly.

Similarly, the warranty will become null and void if the instructions are not adhered to.

© Öhlins Racing AB.

All rights reserved.

Any reprinting or unauthorized use

without the written permission of

Öhlins Racing AB is prohibited.

Printed in Sweden.

Available clamps for Öhlins Steering dampers

Part No.	Fork leg dimension	Clamp dimension
		A x B
2235-01	ø38 mm	38x44
2235-02	ø39 mm	39x45
2235-03	ø40 mm	40x46
2235-04	ø41 mm	41x47
2235-05	ø42 mm	42x48
2235-06	ø43 mm	43x49
2235-07	ø44 mm	44x50
2235-08	ø45 mm	45x51
2235-09	ø46 mm	46x52
2235-10	ø48 mm	48x54
2235-11	ø50 mm	50x56
2235-12	ø51 mm	51x57
2235-13	ø52 mm	52x58
2235-14	ø53 mm	53x59
2235-15	ø53.5 mm	53.5x59,5
2235-16	ø54 mm	54x60
2235-17	ø55 mm	55x61
2235-18	ø56 mm	56x62
2235-19	ø58 mm	58x64

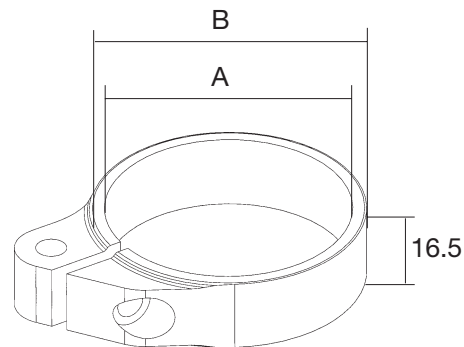

Technical information

Type	Stroke	Mounting length (max/min)
SD 100:	120 mm	35 / 336 mm
SD 110:	90 mm	32 / 276 mm
SD 115:	63 mm	34.5 / 221.5 mm
SD 120:	68 mm	See mounting instruction
SD 121:	68 mm	41 / 237 mm
SD 140:	140 mm	35 / 376 mm
SD 200:	150 mm	35 / 396 mm

Oil:

Öhlins front fork fluid R&T 43, 1309-01.

Grease:

Öhlins red grease, 0146-01.

Loctite glue:

270 for the end eye.

542 for the clamp bolt.

Tightening torque:

M5 Allen screw mounting bracket.

Max torque: 5Nm

4. Steering damper length and stroke

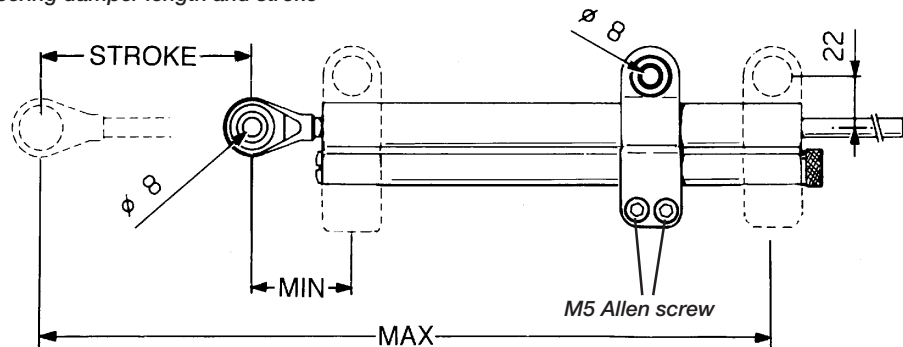

⚠ WARNING!

1. Installing a steering damper, that is not approved by the vehicle manufacturer, may affect the stability of your vehicle. Öhlins Racing AB cannot be held responsible for any personal injury or damage whatsoever that may occur after fitting the steering damper. Contact an Öhlins dealer or other qualified person for advice.

2. Please study and make certain that you fully understand all the mounting instructions and the owners manuals before handling this steering damper kit. If you have any questions regarding proper installation procedures, contact an Öhlins dealer or other qualified person.

3. The vehicle service manual must be referred to when installing the Öhlins steering damper.

NOTE!

During storage and transportation, especially at high ambient temperature, the oil and grease used for assembling may run out inside the packing and damage the expanded polystyrene packing material. This is not unusual and is in no way detrimental to the steering damper.

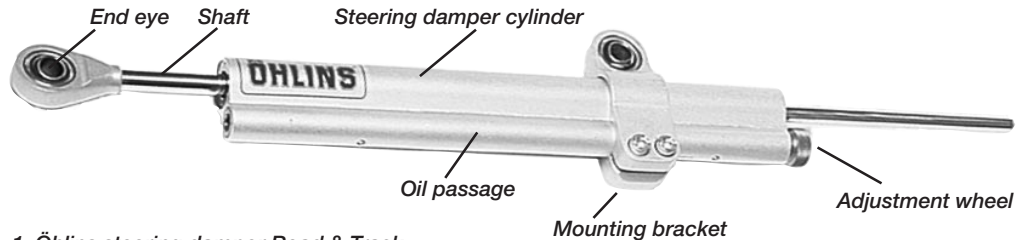

1. Öhlins steering damper Road & Track

Design

The basic function for the Öhlins steering dampers is that the piston, which is fixed on the shaft, pushes oil through a separate parallel passage in the housing, *fig 1*.

An adjustable valve in this passage gives a broad adjustment range.

The settings are made with an adjustment wheel, located on the end of the steering damper cylinder.

PTFE-coated seals are used in the dampers to achieve the lowest friction level possible .

The Öhlins steering dampers are available in several different lengths and strokes, *fig 4*, page 6.

Mountings

The longer models, SD 200 and SD 140, are designed for bikes with wide frames and are mounted on the outside of the fork leg, *fig 2*.

The two shorter models, SD 110 and SD 100, are designed for bikes with conventional frames and can be mounted on the inside of the fork leg.

The super short SD 121 and SD 115 can be mounted conventionally but also across the frame, behind the triple clamp, on bikes with wide frames, *fig 3*.

The SD 120 is the same damper as SD 121 but with mounting brackets designed to fit the standard mounting points on Ducati 916 and 748.

Basic adjustment

The adjustment wheel on the Öhlins steering damper has 16 different positions and counts in number of clicks from maximum hard position.

You set the damper to maximum hard by turning the knob clockwise until it stops.

Start the adjusting of the damper by setting it to 10 clicks counter clockwise towards maximum soft position.

The final setting of the damper is depending on your bike, the road or the track and your riding habits.

If you think your bike feels unstable, turn the adjustment knob clockwise two clicks at a time until you have the performance you desire.

When riding in urban areas we suggest that you set the damper to maximum soft.

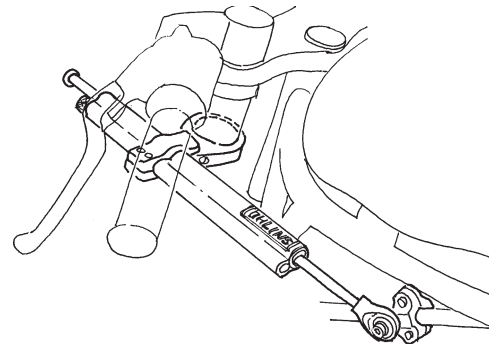

2. Steering damper mounted along the frame

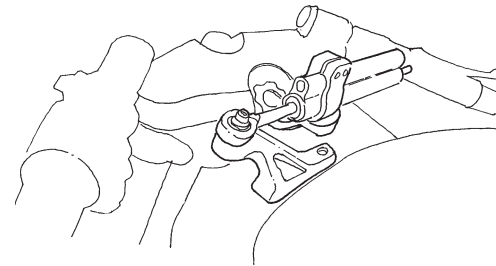

3. Steering damper mounted across the frame